

Hammer-on Beam Clips

Characteristics	C1460	C1461	C1462
Material	Spring steel		
Admissible conductor	Tape conductor thickness 2mm		
Weight (kg)	0.060	0.014	0.014
Thikness E (beam + conducto)	14-20 mm	8-14 mm	3-8 mm
Application	Maintains a tape conductor on metallic beam Requires only a hammer to install		

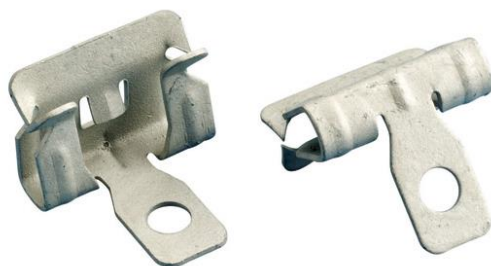

Application

